

Wall Cabinets - I-Timor D

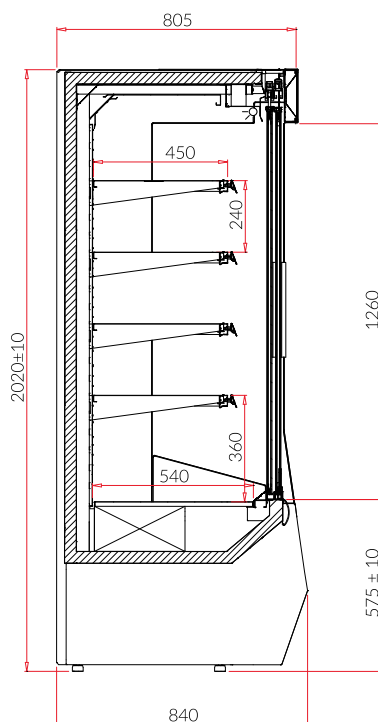

I-Timor SD*



I-Timor SD*

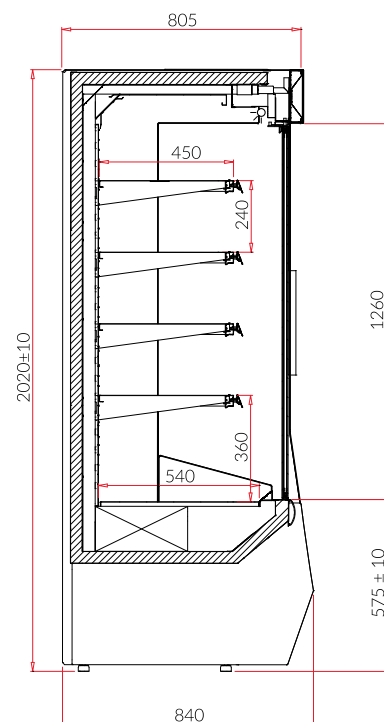

I-Timor HD*

Technical parameters:

Model	Dimension (ext.) H x W x D [mm]	Display surface [m ²]	Shelves with low base	Power Consumption [kWh/24h]	Weight [kg]
I-Timor 1.0 SD/HD	2020 x 1020 x 840	2,20	5	6,80	195
I-Timor 1.3 SD/HD	2020 x 1330 x 840	2,90	5	8,00	240
I-Timor 1.6 SD/HD	2020 x 1630 x 840	3,60	5	10,60	260
I-Timor 1.9 SD/HD	2020 x 1940 x 840	4,30	5	12,70	320
I-Timor 2.5 SD/HD	2020 x 2560 x 840	5,80	5	16,30	375

* - Picture above presents unit with either some or all available extras. Please note that the look of basic version of cabinet, or one of your choice, may vary from presented.

Wall Cabinets - I-Timor D



Description:

- temperature range +2 / +8°C
- preferred ambient temperature +16 / +25°C
- power supply 230V / 50Hz
- internal condensing unit
- ecological polyurethane insulation
- base and front panels made of power coated steel - white colour
- top panel made of perspex with LED illumination - choice of colours
- interior and shelves in white colour
- self closing sliding double glazed glass doors - I-Timor SD
- hinged double glazed glass doors - I-Timor HD
- adjustable shelves
- 4 shelf levels
- interior top LED lighting - white
- price strips - choice of colours
- electronic control with digital temperature display
- automatic defrost
- night blind - manual
- plastic bumper - choice of colours
- ABS side walls with glass - choice of colours
- 1 year full warranty service and after warranty service provided

I-Timor SD*

Available options:

- front panel colour - optional colours
- base colour - optional colours
- front made of stainless steel
- base made of stainless steel
- top panel made of powder coated steel - optional colours
- top panel made of stainless steel
- interior and shelves made of stainless steel
- interior and shelves made of acid resistant stainless steel
- mirrors in side walls
- top mirror instead of top shelf level
- LED lights under each shelf
- meat hooks instead of 2 upper shelf levels
- shelf edge risers
- automatic condensate evaporation
- defrost heaters in evaporator

Choice of colours:

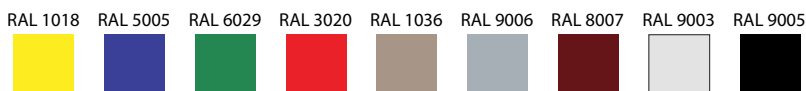

Optional colours:

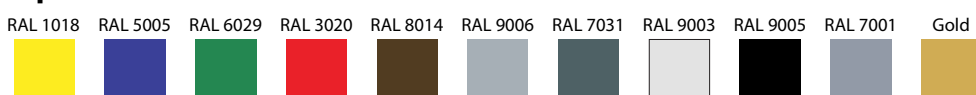

* - Picture above presents unit with either some or all available extras. Please note that the look of basic version of cabinet, or one of your choice, may vary from presented.